

CROCHET DESIGN BASKET



CROCHET DESIGN BASKET

What do you need:

- *Super fine* yarn (at a recommended hook size of 2.5-3.5 mm). I used *Cotone Uni* by *Lana Grossa* (in the colour “Light Grey (027)”; gauge: 10 cm = 23 M)
- I worked with a hook of size 2.5 mm
- Scissors
- An aluminum wire of 2 mm diameter
- Darning needle



Skill level: easy

Finished size (L x W x H): appr. 31 x 28 x 6 cm

The instruction is written in **American English Crochet** terms.

Abbreviations:

sc = single crochet / *st, sts* = stitch, stitches / *sl st* = slip stitch / *ch* = chain / *rd* = round / *MR* = magic ring

© 2021 Trishagurumi

All rights reserved.

You may not sell, redistribute or publish this pattern. Final products made with this pattern can be sold if Trishagurumi is credited as the designer.

We crochet in **joining rounds (as opposed to spiral rounds!)**. Crocheting in joining rounds creates uniform horizontal lines of stitches between two rounds and avoids a spiral look. To crochet in joining rounds, you skip the last st of the round, then sl st in the first st of the new round (which is a ch st), then you ch 1 and continue to st across the round until the next-to-last st. In the new round you repeat this process, i.e. skip last st, sl st in ch st thereafter, ch 1, continue in sc sts until next-to-last st.

INSTRUCTIONS

We do 6 circles: 2 bottom circles, 2 frame circles, and 2 side circles into which the previous 4 circles are attached to and which give the basket its final shape. Each circle includes an inner wire that is worked in at the end of each circle.

Giving my yarn type used, I got the following measures for the circles:

Bottom-circle #1: ch 45 - 18.5 cm circumference and an inner wire of 17 cm length

Bottom-circle #2: ch 95 - 36 cm circumference and an inner wire of 34.5 cm length

Frame-circle #1: ch 150 - 51 cm circumference and an inner wire of 49.5 cm length

Frame-circle #2: ch 195 - 71.5 cm circumference and an inner wire of 70 cm length

Side-circle 2x: ch 195

Each circle is worked in the same way. The illustrations and instructions below describe the steps for the smallest bottom-circle.

Ch 45. Sl st back in 1st ch st to close the chain into a circle.



1. - 3. Rd: ch 1 and continue to work sc sts for the next 44 sts. Skip the 45th st and sl st to the ch st you started the round with.

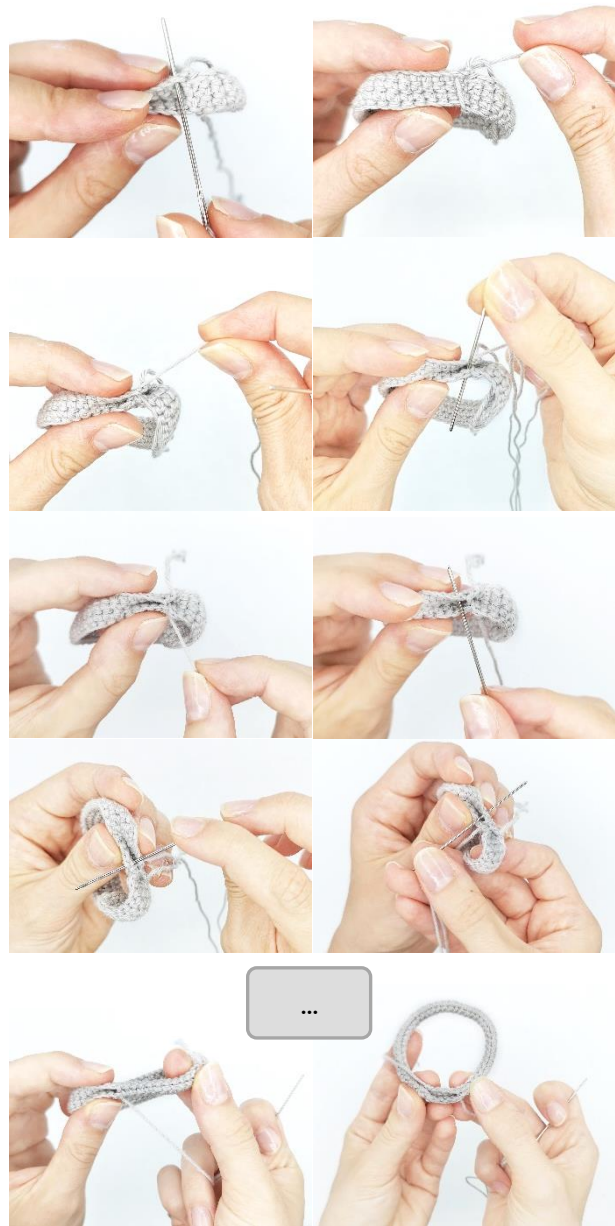
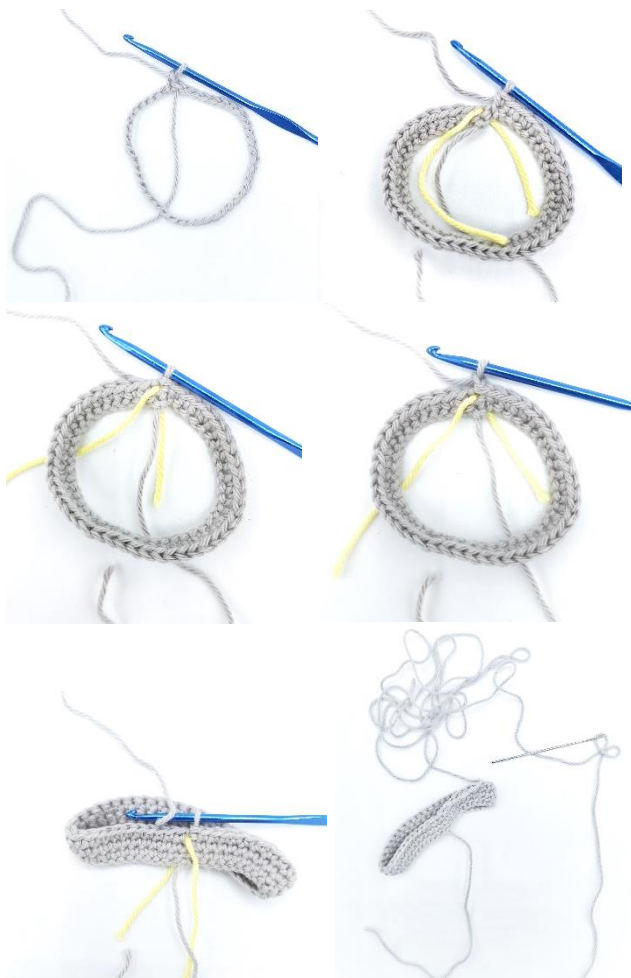

Leave enough yarn tail to sew the bottom and the top of your work together to form a cylinder out of the flat work. When you sew in form of “**hem-stitches**” at each st (without skipping any st), you get the best result (hem-stitching: sew from inside out, stitch after stitch).

Before closing your work, take a wire of 17 cm length and insert it into the piece.

Weave in the yarn ends.

Repeat the steps for the other circles that start with ch 95, ch 150 resp. ch 195:

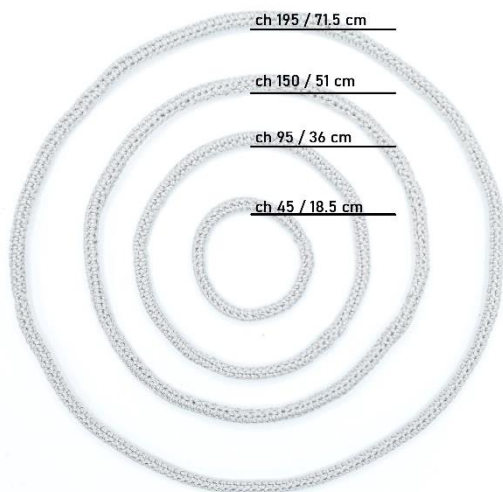

Now, you work the 2 side-circles in the same way (2x ch 195):



We shape the 2 side-circles as follows:
A straight bottom-line of 13 cm, the sides at 130 degrees outwards and a length of about 8.5-9 cm, and a round frame of about 41 cm length facing outwards.

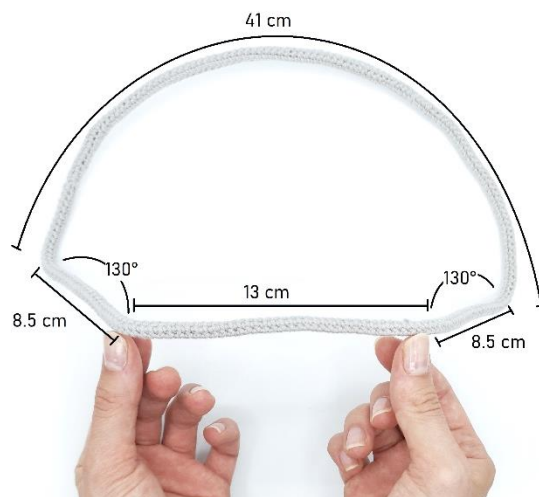

Now, you attach the **bottom** and **frame** circles to the **side** circles as follows: the 2 bottom-circles are attached at the bottom and *below* the side-circles to form the pedestal of the basket. The 2 frame-circles are placed at the inside. In the illustration below, the **yellow** yarn marks the places in which the circles are sewed together / to the side-circles.

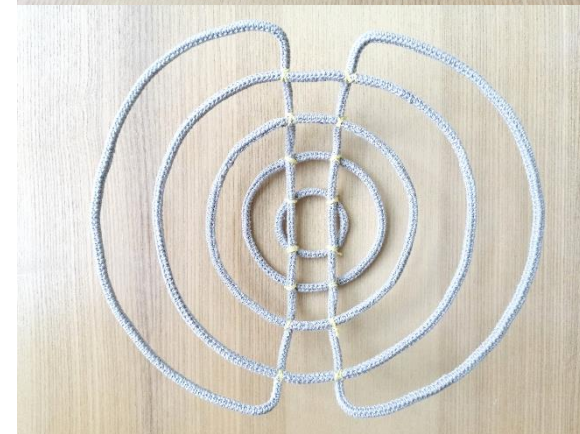



Congrats, you have finished your very own design basket!